



SELECTABLE LED TROFFER Sensor Based



PRODUCT DESCRIPTION

The selectable sensor based troffer comes in 2x2, 2x4 and 1x4 configurations. Sensor receptacle is pre-installed on the fixture. Plug and play occupancy and bluetooth sensors available for easy and quick installation. Ideal for standard T-bar and narrow grid drop ceiling to replace the fluorescent troffer in offices, supermarkets, schools and other indoor applications.

FEATURE

- Color temperature selectable
- Wattage selectable
- Plug and play sensor
- Emergency back up optional

ELECTRICAL SYSTEM

- Input Voltage: 120-277V, 50/60Hz
- 0-10V Dimmable
- Minimum Ambient -4°F, maximum 104°F
- Power Factor: > 0.98 at 120V
- Total Harmonic Distortion: < 20% at 120V

SPECIFICATION

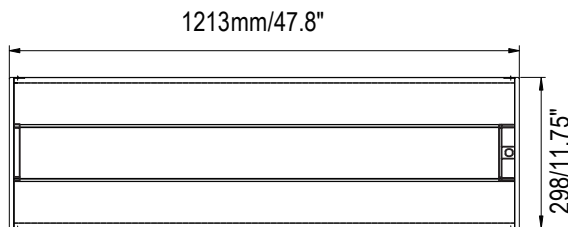

1x4

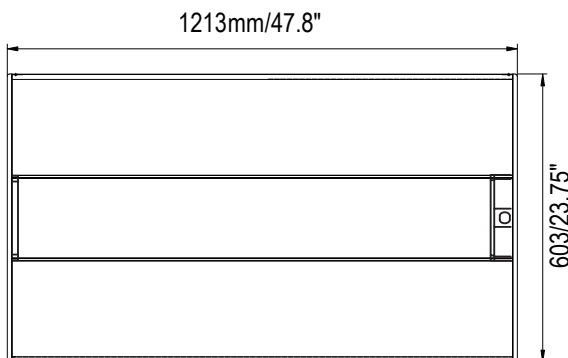

2x4

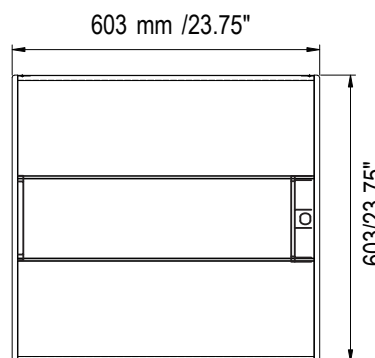

2x2

PERFORMANCE

CRI

80

CCT

3500K、 4000K、 5000K

Dimming

0-10V Dimming

Projected Lifetime

L70 - 100,000 Hours

Working Temperature

-4-104°F (-20-40°C)

Certifications

- cULus Listed
- Suitable for damp locations
- RoHs compliant

Ordering Information

Example: TRSB-24D-SP1-SW1

Name	.Size	Dimmable	. Watts	. CCT	Voltage	.Control	.Finish
TRSB	22-2x2 FT	D - 0-10V Dimmable	SP1 - Selectable Power 20W/25W/30W ¹	SW - Selectable White 3500K/4000K/5000K ³	1- 120-277V	Blank- With Sensor Receptacle	Blank-White
	14-1x4 FT		SP1 - Selectable Power 20W/25W/30W ¹			EBU-Emergency Battery Backup ⁴	
	24-2x4 FT		SP1 - Selectable Power 34W38W/45W ²				

Notice:

- 30W is default setting. If need other wattage, please change the setting in the field.
- 45W is default setting. If need other wattage, please change the setting in the field.
- 4000K is default setting. If need other CCT please change the setting in the field.
- Emergency battery backup is available in 8W with 1100lm and works for a minimum of ninety (90) minutes. Emergency battery back-up is installed at the back of the housing. It is for ambient temperatures of 32°F -95°F (0 °C -35°C).

* White finish is standard. Custom color is available for a premium setup fee. Consult customer service for additional information.

Accessories (Ordered separately)



ANT-1P-4T-BLE

Bluetooth
Motion Sensor



ANT-1P-4T

PIR
Motion Sensor

AAL-RC-100

Remote control for
the PIR sensor only



2x2 Surface Mount Kits



2x4 Surface Mount Kits



1x4 Surface Mount Kits

Notes

* Factory default setting for PIR sensor : 100% sensitivity, Hold on time: 5min, Daylight sensor is ☀ , Dimming level :30%
Dimming time: 60 minutes. PIR sensor is for mounting height of 12ft (4m) max..

* Sensor data can only be reset by a user manual APP. Please contact Customer Service for APP details.

PHOTOMETRY

All published luminaire photometric testing performed to IESNA LM-79-08 standards by a NVLAP certified laboratory.

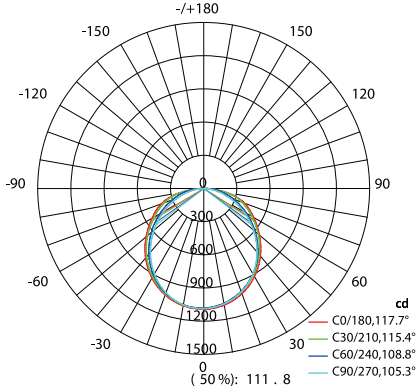

PERFORMANCE DATA

LUMEN OUTPUT

Lumen values are measured by third party certified laboratories performed in accordance with IESNA LM-79-08 as well as Lighting Facts listed.

Watts	Lumen Output	Size	CRI	CCT	LPW
20W	2500	2X2	>80	4000K	125
25W	3200	2X2	>80	4000K	128
30W	3900	2X2	>80	4000K	130
34W	4250	2X4	>80	4000K	125
38W	4760	2X4	>80	4000K	125
45W	5800	2X4	>80	4000K	129

Sensor Receptacle is pre-installed



BLUETOOTH MICROWAVE MOTION SENSOR (ANT-1P-4T-BLE)

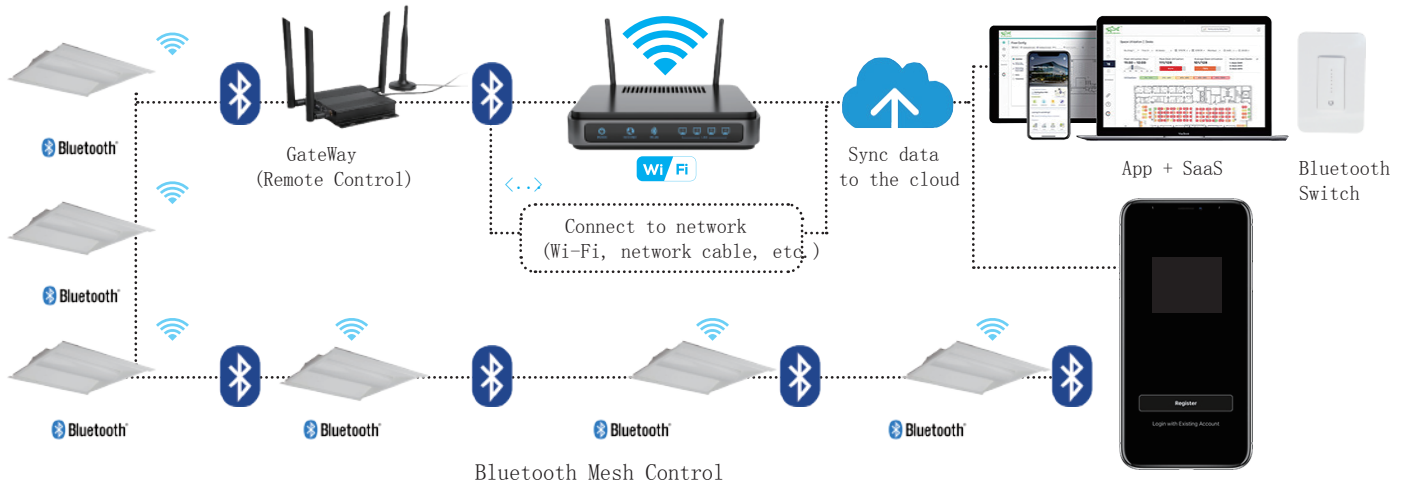

SPECIFICATIONS

The Bluetooth Fixture Sensor is designed for indoor applications with ceilings such as office, school. Integrated sensors capture data that is both processed locally and transmitted over the network, enabling a full suite of applications. In addition, the sensor supports Bluetooth® Low Energy communication with tags and other BLE devices.

OVERVIEW

The Bluetooth Fixture Sensor is a complete sensing and lighting control node powered from its attached light fixture. Sensor information combined with a configurable behavior profile makes the fixture Sensor an integral component of an intelligent lighting control and sensing solution. With integrated wireless communications for data transmission and remote configuration as well as autonomous fixture-level control, this sensor brings advanced lighting automation to a whole new level.

FEATURES AND BENEFITS

Sensor DLC: Meet DLC 5.2 Networked Lighting Control System.

Localized Lighting Control: Light-level schedules, preferences, and profiles for each fixture are wirelessly communicated at system setup and stored for continuous operation.

Bluetooth Low Energy: An embedded BLE radio allows the sensor to receive and transmit beacons as well as support communication with lighting control devices and other sensors.

Occupancy/Vacancy/Manual: A digital Passive Infrared (PIR) sensor combined with ambient with 3 difference modes as options.

Daylight Harvesting: Captured ambient light information is locally processed to raise and lower light levels based on available daylight.

Room and Zone Control: Pairs with room switches for code-compliant manual-on or auto-off capability. Sensors can be grouped into zones that share occupancy sensing data and coordinate light control based on detected motion.

TECHNICAL DATA

Motion Sensing	Passive IR
Input Power	12-24VDC, >50mA
Control Output	0-10V, max 25mA sinking current
Mounting height	12ft(4m) Max.
Detection angle	360°
Operating temperature	-20°C~60°C
IP rating	20
Wireless Standards	5.0 Bluetooth Mesh

Warranty

Five year limited warranty.

Specifications subject to change without notice.