



The MACK LED Bollard comes in simple and modern rectangular design. Fully shielded design used to control unwanted light in residential areas. This bollard has UV powder coated die cast high quality aluminum body, tempered safety glass, moulded silicone gasket and stainless steel screws. This bollard is an excellent choice for walkways, entrances, promenades, plazas, courtyards, driveways, bridges, and landscaped areas.

TECHNICAL DATA

Wattage	10W
CCT	3000K, 4000K
Dimming	Non-Dimming
CRI	80
Input Voltage	120-277V, 50/60Hz
Projected Lifetime	L70-100,000 Hours
Operating Temp.	-30°C to 40°C (-86°F to 104°F)
Certifications	cETLus
	RoHS compliant
Power Factor	>0.9 @120Vac
Harmonic Distortion	<20% at full load
IP Rating	IP65

FEATURES

- Fully shielded design.
- Die cast aluminum body.
- Tempered safety glass.
- IP65 rated for wet location.

SPECIFICATION

Dimension

Side View

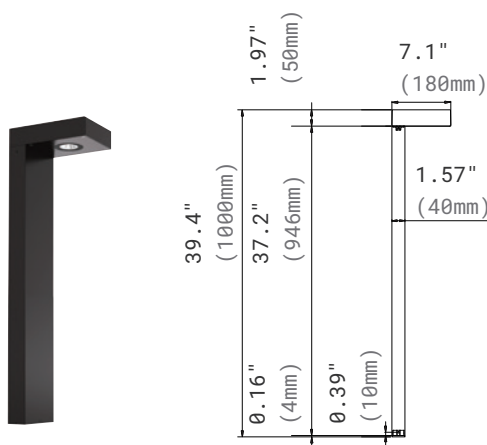

Base Plate

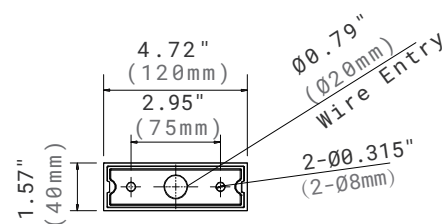

Anchor Bolt

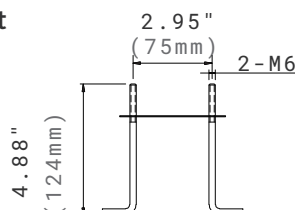

ORDERING INFORMATION

EXAMPLE: MBD40H-10401-V-BK

MBD							
Series	Height	Wattage	CCT	Voltage	Controls	Distribution	Finish
MBD Mack Bollard	40H 39.4" Height	10 10W	30 3000K 40 4000K	1 120-277V	Blank On/Off	V Type V	BK Black Optional Finish Colors (Additional Charge applied) ¹

NOTE:

1. Black finish is standard. Additional charges will apply for all the other colors. Please contact Customer Service for premium options.

ACCESSORIES(ORDERED SEPARATELY)

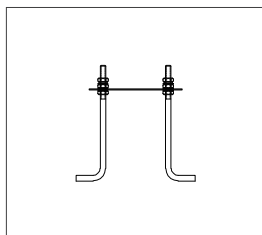

ABMK-MBD

Anchor Bolts Mounting Kits .

PERFORMANCE DATA

Lumen values are measured by third party certified laboratories performed in accordance with IESNA LM-79-08 as well as Lighting Facts listed.

Wattage	Lumen Output	AC Input 120V	CRI	CCT	LPW
10W	700lm	0.08A	80	3000K	70

BUG RATING TABLE

Performed to IESNA LM-79-08 standards by a NVLAP accredited laboratory.

Model	BUG Rating
MBD40H-10301-V-BK	B0-U0-G0

WARRANTY

5 year limited warranty.

Specifications subject to change without notice.