



Family Product

LED Moon Series Bollard



Moon Series Garage and
Canopy Fixture



The Moon Series offers a high-performance solution for the most demanding applications packaged in a unique and easy to install design. With different precision refractive optical lenses and versatile mounting options including post top, low bay, parking garage, and gas station canopy, this luminaire can be used in many applications such as pedestrian street, factories, schools, gardens, courtyards, hotels, parking lots, and public parks.

TECHNICAL DATA

Wattage	35W, 50W, 75W, 100W, 135W
CCT	3000K, 4000K, 5000K
Dimming	
35W/50W/75W	0-10V Dimmable driver
100W/135W	1-10V Dimmable driver
CRI	≤50W, 70 CRI
	>50W, 80 CRI
Input Voltage	120-277V/347V/480V, 50/60Hz
Projected Lifetime	L70-109,000 Hours
Operating Temp.	
35W/50W/75W/100W	-40°F to 131°F (-40°C to 55°C)
135W	-40°F to 104°F (-40°C to 40°C)
Certifications	cETLus conforms to UL Std. 1598
	Cert. to CSA Std. C22.2 No.250.0
	RoHS compliant
	DLC qualified*
	DarkSky Approved*
Power Factor	>0.9 at full load
Harmonic Distortion	<20% at full load
IP Rating	IP66
IK Rating	IK10 rated for polycarbonate lens

Notes:

- * If you find configurations are not shown as DLC listed, please do not hesitate to inquire with Customer Service.
- * Only 3000K or less is DarkSky approved.

FEATURES

- Easy and convenient for installation.
- Lightweight design and low E PA minimize pole load.
- Die-cast aluminum housing and excellent thermal management.
- IES distribution Types II, III & V for various applications.
- Tempered glass lens doesn't fade and discolour.
- Multi-level motion sensor, photocontrol and 3/5/7-pin NEMA receptacle options.
- Integral 10KA surge suppression protection standard.
- Dimming wires are pre-installed inside the fixture. If dimming wires need to be accessed, please contact Customer Service.

DIMENSION

Moon Series Post Top

Max. Weight: 16.54lbs

Effective Projected Area (EPA): 0.7ft²

Suitable for Ø2-3/8" to 3" Pole

(Ø60.3mm to 76.2mm)

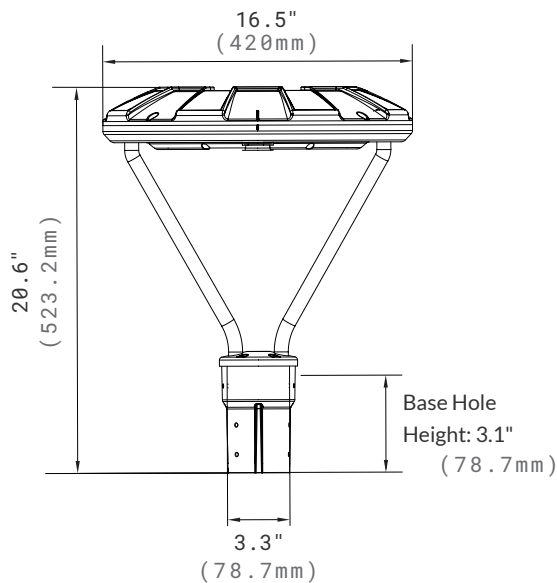

Wall Mount Bracket

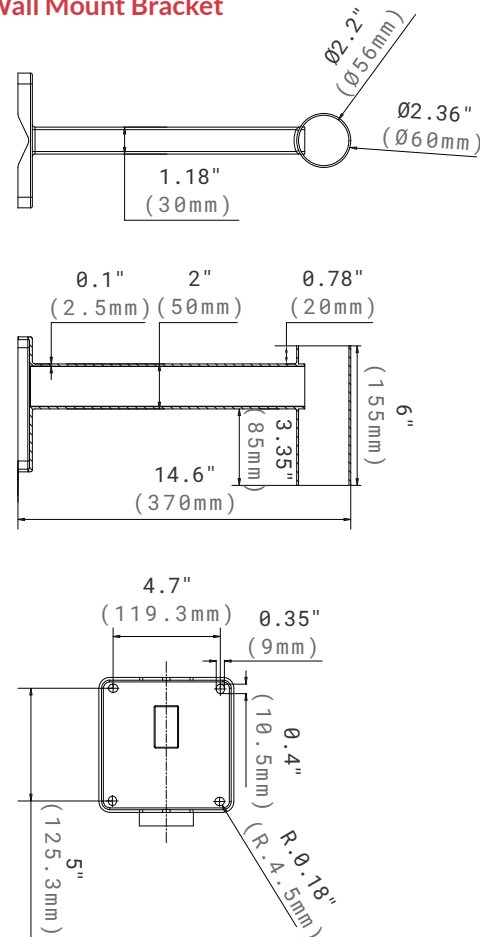

ORDERING INFORMATION

EXAMPLE: MPT35501-MS-L3B-P1-V

MPT								
Series	Wattage	CCT	Voltage	Control	Installation	Distribution	Lens	Finish
MPT	35 35W	30 3000K	1 120-277V	BLANK On/Off	P1 2-3/8" or 3" Tenon Pole ⁶	II Type II III Type III V Type V	BLANK Glass Clear Lens ⁷	BLANK Dark Bronze
	50 50W	40 4000K	2 347V ¹	MS-L3B Wattstopper Sensor With Black L3 Lens ⁴			GFL Glass Frosted Lens	Custom colours are available for additional charge. ¹⁰
		50 5000K	6 120-347V ³	MS-L7B Wattstopper Sensor With Black L7 Lens ⁴			PCL Polycarbonate Clear Lens ⁸	
	75 75W	30 3000K	1 120-277V	PC Photoelectric Control			PDL Polycarbonate Diffused Lens ⁸	
	100 100W	40 4000K	2 347V ¹	7P 7-Pin PE Receptacle ⁵				
	135 135W	50 5000K	3 480V ²	SRP Bluetooth Sensor Receptacle ⁹				
			6 347/480V ³					

NOTE:

1. Single voltage 347V is only used with photoelectric control.
2. Single voltage 480V is only used with photoelectric control.
3. No controls for 120-347V and 347/480V.
4. Wattstopper sensor is not available for 120-347V and 347/480V. Black L3 lens is standard for 35W and 50W. Black L7 lens is standard for 75W, 100W and 135W. Please check the motion sensor manual for more information.
5. Sensor is by others. Shorting cap included.
6. 4" OD round and square pole adapter is available for accessory.
7. Glass clear lens is standard. For other lens options (GFL/PCL/PDL), please check with Customer Service for lead-times.
8. Polycarbonate lens is IK10 rated.
9. The Bluetooth PIR sensor need to be ordered separately and field installed. It is suitable for a max mounting height of 40ft Max.
10. Dark Bronze finish is standard. Custom finish colors are available at an additional charge. Please contact Customer Service for premium options.

ACCESSORIES (ORDERED SEPARATELY & FIELD INSTALLED)



90178
MPT-4PRA
4" OD Round Pole Adapter.

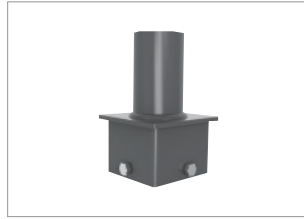

90534
MPT-4SPA
4" Square Pole Adapter.



91255
WM-BRACKET-01-BK
Wall Mount Brackets,
Black.

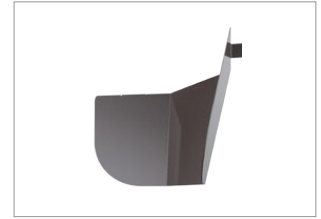

90198
MPT-HSS
House Side Shield For
MPT/MLB.

PHOTOMETRY

All published luminaire photometric testing performed to IESNA LM-79-08 standards by a NVLAP certified laboratory. IESNA LM-79-08 specifies the entire luminaire as the source resulting in a fixture efficiency of 100%. Results may vary per actual order.

With Clear Lens

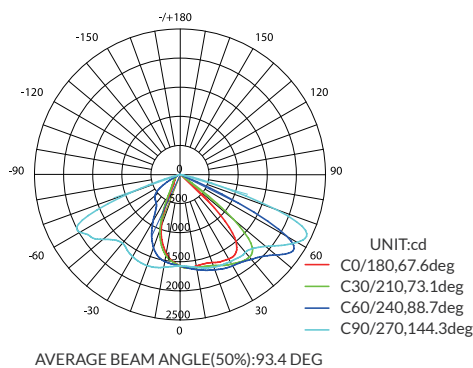

Type II

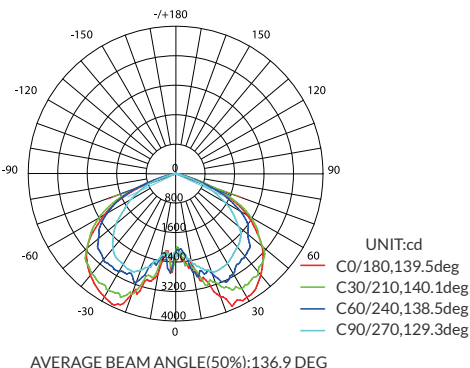

Type V

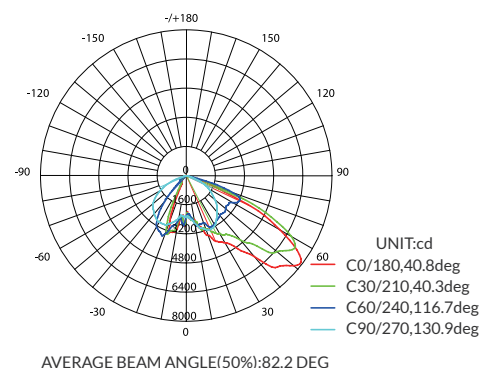

Type III

PERFORMANCE DATA

Lumen values are measured by third party certified laboratories performed in accordance with IESNA LM-79-08 as well as Lighting Facts listed.

Lumen Output

With Clear Glass Lens

Nominal Wattage	System Wattage	Lumen Output (Post Top)	CRI	CCT	Distribution Type	LPW
35W	35W	4039lm	80	5000K	Type V	115
50W	47.8W	5319lm	80	3000K	Type III	111
75W	72.1W	8057.4lm	70	5000K	Type III	111.8
100W	99.4W	11595lm	70	5000K	Type V	116.7
135W	133W	16500lm	70	5000K	Type V	124

Notes: 0.89 multiplier is for frosted glass lens.

Lumen Multiplier	
3000K	0.93
4000K	1
5000K	1
Clear Glass Lens	1
Frosted Glass Lens	0.89

Projected LED Lumen Maintenance

Data references the extrapolated performance projections for the LED security light in a 77°F ambient, (tested per IESNA LM-80-08 and projected per IESNA TM-21-11).

100W (351B)				
Operating Hours	10,000	16,000	29,000	109,000
Lumen Maintenance Factor	0.98(L98)	0.96(L96)	0.92(L92)	0.70(L70)

75W (5630)				
Operating Hours	11,000	16,000	27,000	97,000
Lumen Maintenance Factor	0.98(L98)	0.96(L96)	0.92(L92)	0.70(L70)

BUG RATING TABLE

Performed to IESNA LM-79-08 standards by a NVLAP accredited laboratory.

Model	BUG Rating	Model	BUG Rating	Model	BUG Rating
MPT35301-II	B1-U2-G0	MPT50401-III	B2-U2-G1	MPT75501-V	B3-U3-G1
MPT35401-II	B1-U2-G0	MPT50501-III	B2-U2-G1	MPT100301-II	B3-U3-G1
MPT35501-II	B1-U2-G1	MPT50301-V	B2-U2-G1	MPT100401-II	B3-U3-G1
MPT35301-III	B2-U1-G1	MPT50401-V	B2-U2-G1	MPT100501-II	B3-U3-G1
MPT35401-III	B1-U2-G0	MPT50501-V	B2-U2-G1	MPT100301-III	B3-U2-G2
MPT35501-III	B2-U1-G1	MPT75301-II	B2-U3-G1	MPT100401-III	B3-U3-G2
MPT35301-V	B2-U1-G1	MPT75401-II	B2-U3-G1	MPT100501-III	B3-U2-G3
MPT35401-V	B2-U2-G1	MPT75501-II	B2-U3-G1	MPT100301-V	B3-U2-G2
MPT35501-V	B2-U1-G1	MPT75301-III	B2-U2-G2	MPT100401-V	B3-U3-G3
MPT50301-II	B2-U2-G1	MPT75401-III	B2-U3-G1	MPT100501-V	B3-U2-G3
MPT50401-II	B2-U2-G1	MPT75501-III	B2-U2-G2	MPT135501-P1-II	B3-U3-G1
MPT50501-II	B2-U2-G1	MPT75301-V	B3-U2-G2	MPT135501-P1-III	B3-U3-G2
MPT50301-III	B2-U2-G1	MPT75401-V	B3-U3-G1	MPT135501-P1-V	B3-U3-G3



Multi-level Motion Sensor



120-277V Photocontrol



480V Photocontrol

BLUETOOTH PIR MOTION SENSOR

Bluetooth Mesh Control

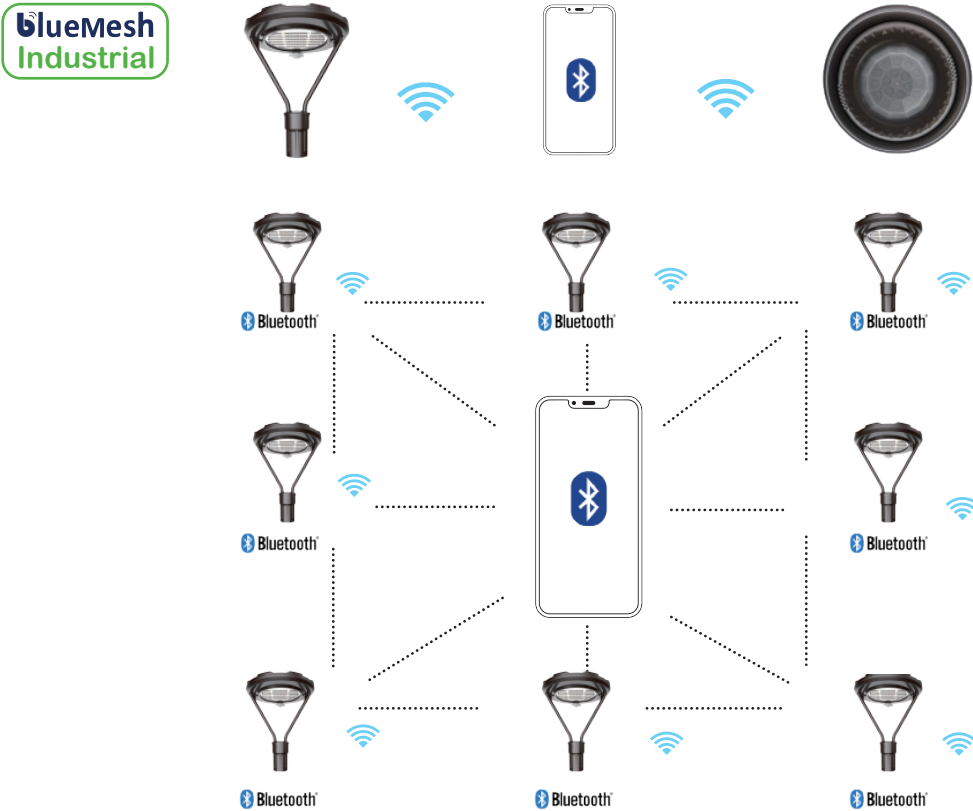

Model Number	Description	Input Voltage	Output
BMS-M100-PIR-DC1-BLE-SR-Z10-BZ	Fixture controller with 0-10V dimming, PIR motion sensor, bluetooth mesh in BlueMesh®, standard dark brown colour.	12-24VDC	Control High 0-10V Dimming
BMS-M110-PIR-DC1-BLE-SR-Z10-BZ	Fixture controller with 0-10V dimming, PIR motion sensor, light sensing, bluetooth mesh in BlueMesh®, standard dark brown colour.	12-24VDC	Control High 0-10V Dimming
BMS-M100-PIR-DC1-BLE-SR-Z10-WH	Fixture controller with 0-10V dimming, PIR motion sensor, bluetooth mesh in BlueMesh®, white colour, Silvair technology partner.	12-24VDC	Control High 0-10V Dimming
BMS-M110-PIR-DC1-BLE-SR-Z10-WH	Fixture controller with 0-10V dimming, PIR motion sensor, light sensing, bluetooth mesh in BlueMesh®, white colour.	12-24VDC	Control High 0-10V Dimming
BMS-M100-PIR-DC1-BLE-SR-Z10-BK	Fixture controller with 0-10V dimming, PIR motion sensor, bluetooth mesh in BlueMesh®, black colour.	12-24VDC	Control High 0-10V Dimming
BMS-M110-PIR-DC1-BLE-SR-Z10-BK	Fixture controller with 0-10V dimming, light sensing, bluetooth mesh in BlueMesh®, black colour.	12-24VDC	Control High 0-10V Dimming
LS01-LB-F3-XX	360° Low Bay Lens, maximum coverage 60ft diameter at 30ft and 40ft height –replace –XX with –BN for brown finish, –BK for black finish or –WT for brown finish.		
LS01-HB-F3-XX	360° High Bay Lens, maximum coverage 80ft diameter at 30ft-40ft height – replace –XX with –BN for brown finish, –BK for black finish or –WT for brown finish.		

Detection Area

High Bay Lens - Top View at 8 ft (2.4m)

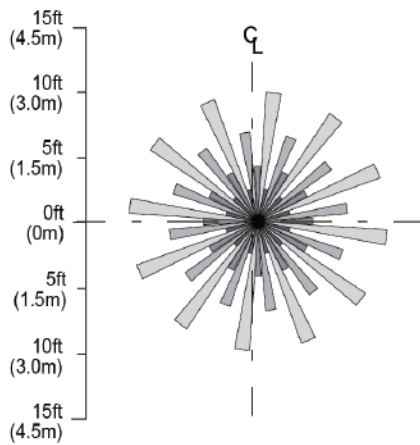

Side View

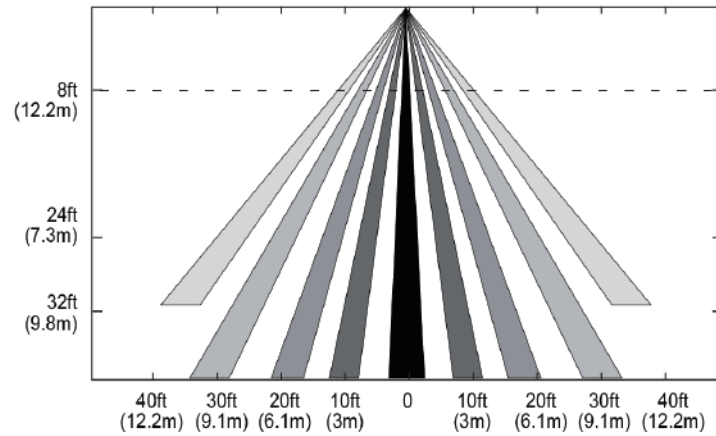

Low Bay Lens - Top View at 8 ft (2.4m)

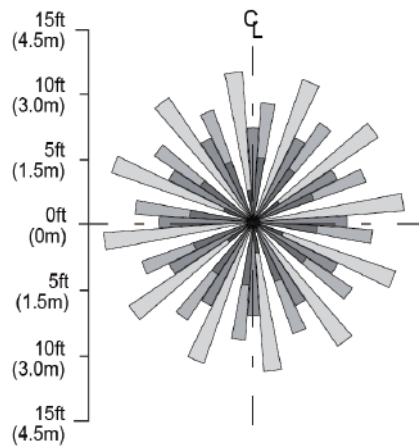

Side View

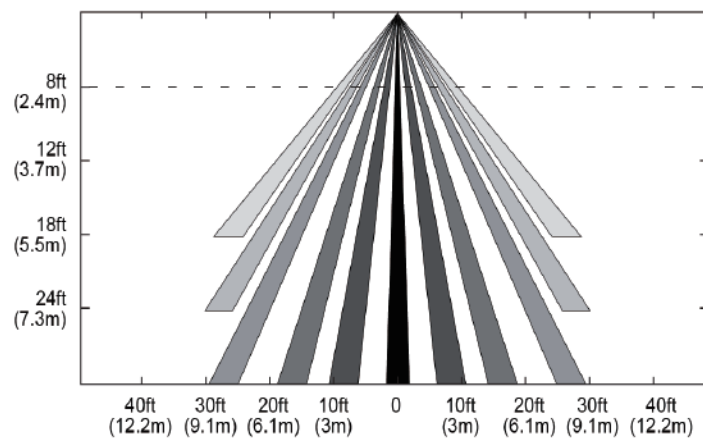

WARRANTY

5 year limited warranty.

Specifications subject to change without notice.

Ref#: 20250723