

WARNING: Installation and servicing to be performed only by qualified personnel. If not qualified, consult an electrician. Risk of Electrical Shock! Disconnect power at fuse or circuit breaker before installing or servicing.

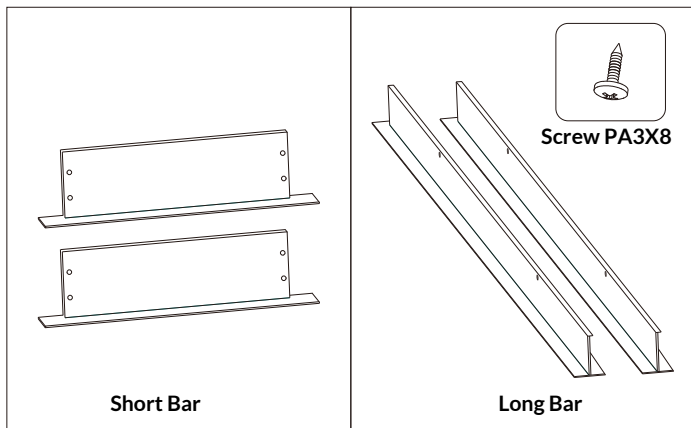

Size Of Luminaire	Ceiling Opening Size
L 2' X W 4"	L 24 -3/4" X W 4 -3/4"
L 2' X W 6"	L 24 -3/4" X W 6 -3/4"
L 2' X W 2'	L 24 -3/4" X W 24 -3/4"
L 4' X W 4"	L 48 -3/4" X W 4 -3/4"
L 4' X W 6"	L 48 -3/4" X W 6 -3/4"
L 4' X W 1'	L 48 -3/4" X W 12 -3/4"
L 4' X W 2'	L 48 -3/4" X W 24 -3/4"
L 8' X W 4"	L 96 -3/4" X W 4 -3/4"
L 8' X W 6"	L 96 -3/4" X W 6 -3/4"

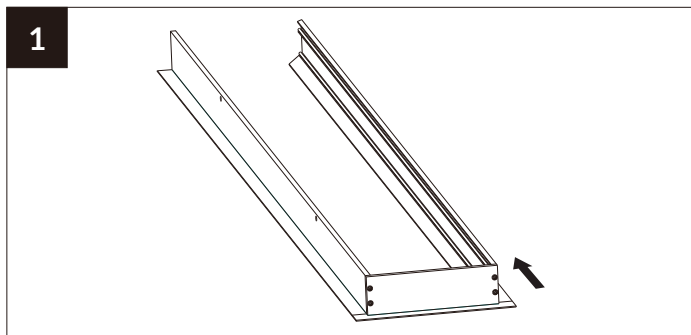

Joint the 2pcs long bars and 1pc short bar together with screws

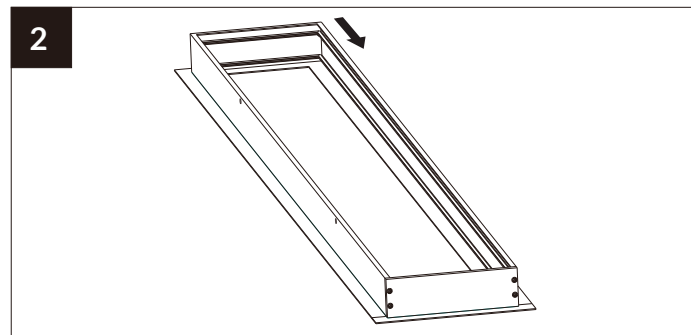

Then joint these 2pcs long bars and another short bar together with screws.

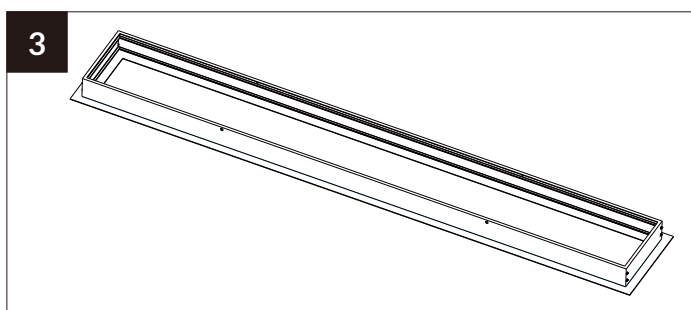

Assembly complete

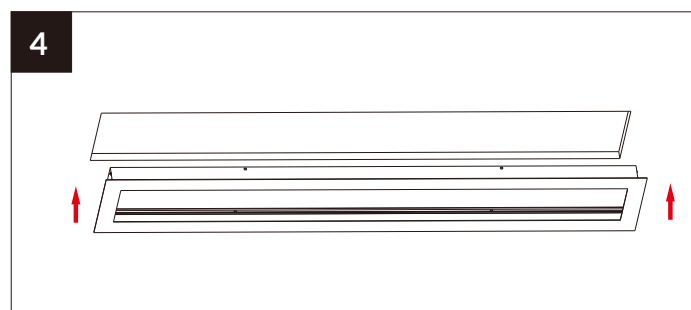

Embed this flange kit through the ceiling opening

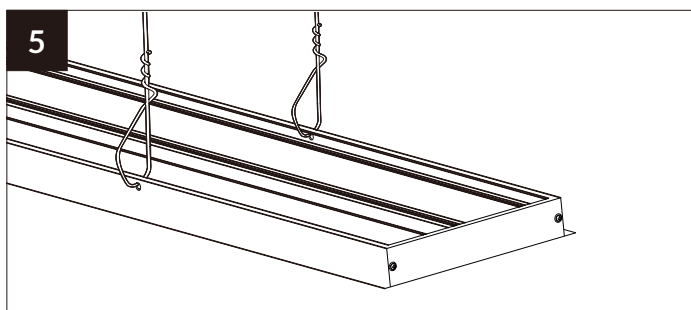

Fix the aircraft cable on the long bar

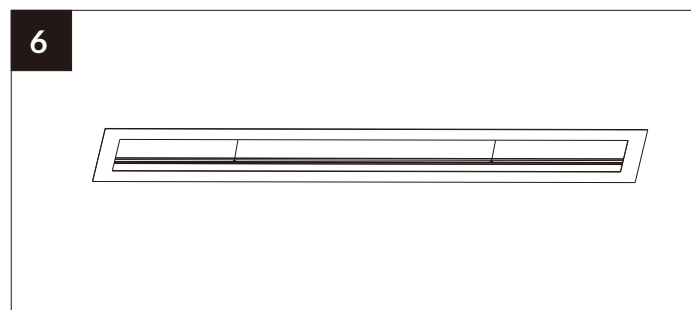

Suspend the flange kit to level with the ceiling, installation complete.