

# ECO VISION LED STRIP

Wide Size Ideal To Replace The 2 Lamp Fluorescent Strip



Above All Lighting's ECO Vision Strip has a sleek design with a diffuser lens. 135LPW with high efficiency performance and a wide lumen range from 2,700lm to 11,000lm, the ECO Vision Strip comes in standard lengths of 4ft and 8ft. Built-in sensor is available. Optional accessories include reflector, wire guard, V-hook and quick surface mount kits. It can be widely used in stairwells, warehouses, offices, garages, shop displays, and other commercial applications.

## TECHNICAL DATA

Length	2ft, 3ft, 4ft, 8ft
Wattage	20W, 30W, 45W, 60W, 80W, 90W
CRI	80
CCT	3000K, 3500K, 4000K
Driver	0-10V Dimming, Class 2 driver
Input Voltage	120-347V, 50/60Hz
Operating Temp.	-4°F to 104°F (-20°C to 40°C )
	* Maximum temperture is 95°F (35°C) for 4ft, 90W
Certifications	cETLus conforms to UL Std. 1598
	Cert. to CSA Std. C22.2 No.250.0
	Suitable for damp locations
	RoHs compliant
Power Factor	>0.9 at full load
Harmonic Distortion	<20% at full load
Projected Lifetime	L70 - 156,000 Hours
IK Rating	IK10 rated

## FEATURES

- 8% up-light and no glare.
- Quick and Easy to wire and install.
- Seamless connection.
- Built-in sensor.
- EBU backup available.
- Ceiling & wall surface mounted, suspension mounted.

# ECO VISION LED STRIP

Wide Size Ideal To Replace The 2 Lamp Fluorescent Strip

## SPECIFICATION

### Side View

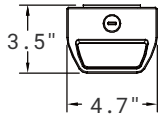

### With Two Reflectors

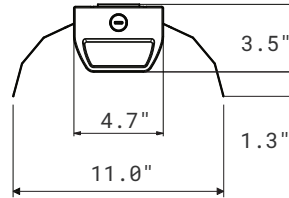

### 2ft

Net. Weight: 4.5 lbs

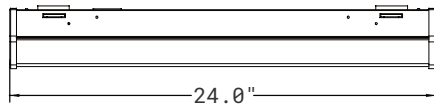

### 3ft

Net. Weight: 5.9 lbs

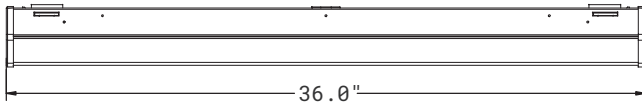

### 4ft

Net. Weight: 7.5 lbs

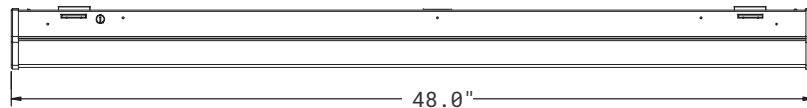

### 8ft

Net. Weight: 13.5 lbs

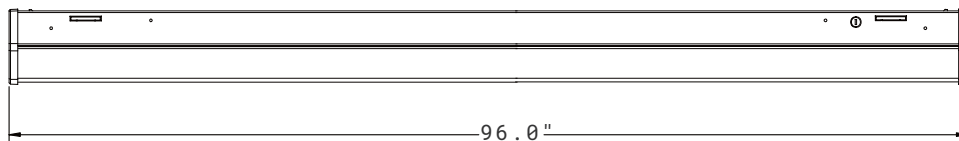



### ORDERING INFORMATION

EXAMPLE: STR12D30LED408F-SE

Strip					
1. Series	2. Dimension	3. Dimmable	4. Wattage	5. LED	6. CCT
STR	06 2ft	D 0-10V Dimmable	20 20W	LED	30 3000K
	09 3ft <sup>4</sup>	D 0-10V Dimmable	26 30W		35 3500K
	12 4ft	D 0-10V Dimmable	20 20W  30 30W  45 45W  60 60W <sup>5</sup>  90 90W <sup>5</sup>		40 4000K
	24 8ft	D 0-10V Dimmable	60 60W  85 80W		
	7. Voltage	8. Lens	9. Control	10. Series	
	8 120-347V	F Frosted lens <sup>3</sup>  C Clear lens <sup>3</sup>	BLANK None  MSW Microwave Dimming Sensor <sup>1&amp;7</sup>  EBU Emergency Battery Back-up <sup>2</sup>	SE ECO	

### NOTE:

1. Microwave dimming sensor for mounting height 20ft max. Dimming default setting is Bi-Level dim, 50% on vacancy and 100% on Occupancy. Daylight sensor default set to disabled. Other dimming levels such as 20% or 30%, ON/OFF function and daylight sensor can be set by the remote controller MH10.
2. Emergency battery back-up is not available for 4ft@ 90W. It is for ambient temperatures of 32°F to 95°F (0°C to 35°C). The emergency test button is pre-installed on the fixture. The standard emergency test button is plastic. Metal emergency test button is optional. The EBU is Title 20 compliant. Emergency battery backup is available in 8W with 1360lm and works for a minimum of ninety (90) minutes.
3. Frosted lens is standard. Please contact Customer Service for the lead time of clear lens.
4. 3ft is without DLC. Please contact Customer Service for lead time of 3ft vision strip.
5. 4ft@ 90W are not available for Emergency Battery Back-up. Maximum temperature is 86°F (30°C) for 4ft@ 60W Emergency Battery Back-up.
6. Surface mount is standard. If quick surface mount or V-hook mount is needed, please order the mounting brackets separately. Please check the accessory table for details.
7. MSW can read vibration as movement and trigger the sensor despite no physical movement in the sensor field. As such, MSW should not be installed in rooms that experience significant levels of vibration.
8. Standard Finish is White. Custom colors might be available for an additional fee. Please check with Customer Service for more information.

### ACCESSORIES (ORDERED SEPARATELY)

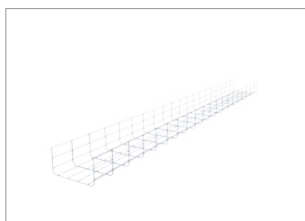

**90237**  
STRP06-WG  
Wire guard for 2ft strip.

**90238**  
STRP12-WG<sup>1</sup>  
Wire guard for 4ft and 8ft strip.



**90264**  
STRP-QSMK<sup>3</sup>  
Quick surface mount kit for ceiling and wall mount (a pair).

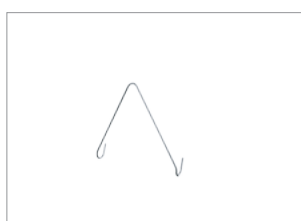

**90243**  
STRP-VH<sup>4</sup>  
V-hooks for strip.

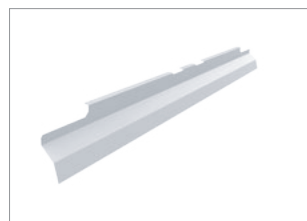

**90240**  
STRP06-RF  
Reflector 2ft strip.

**90242**  
STRP12-RF<sup>2</sup>  
Reflector 4ft and 8ft strip.

### NOTE:

1. If for 8ft please order two pieces.
2. If this reflector will be installed at one side, then one piece for 4ft and two pieces for 8ft. If this reflector will be installed at both two sides, then two pieces for 4ft and four pieces for 8ft.
3. Soft chain mount with V-hooks is the best choice if fixture is with MSW and needed to be installed on a ceiling of long time vibration.

# ECO VISION LED STRIP

Wide Size Ideal To Replace The 2 Lamp Fluorescent Strip



**ABOVE ALL**

www.AboveAllLighting.com

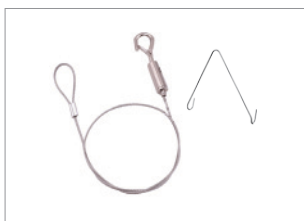

**90759**  
STR-PMK  
Pendant Mount Kits for  
strip (a pair).



**BMS-L104-B1-PIR-1-BLE-  
KL-SMO**  
Passive Infrared (PIR)  
Bluetooth Sensor.



**90576**  
MH10  
Remote control for MSW.

## PHOTOMETRY

All published luminaire photometric testing performed to IESNA LM-79-08 standards by a NVLAP certified laboratory. IESNA LM-79-08 specifies the entire luminaire as the source resulting in a fixture efficiency of 100%. Results may vary per actual order.

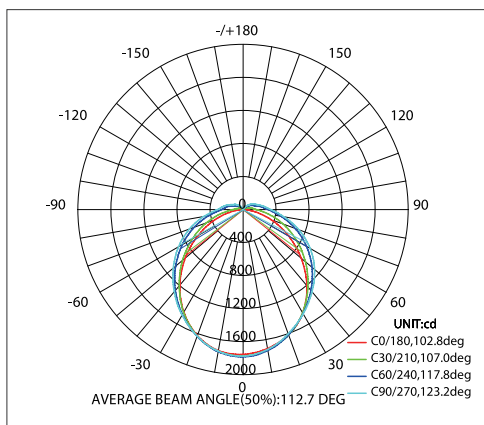

Built-in sensor.



EBU backup available.  
The standard emergency  
test button is plastic.  
Metal emergency test  
button is optional.



Easy to wire. End and back  
side wire entries  
available, meet different  
junction box locations.

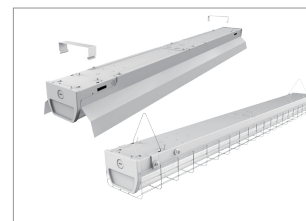

Easy to install. Quick  
ceiling & wall surface  
mount and V-hook  
mount optional, no need  
to open the housing.

## PERFORMANCE DATA

Lumen values are estimated with LED data sheet.

### Frosted Lens

Wattage	Lumen Output	Size	CRI	AC Input 120V	CCT	LPW
20W	2700lm	2ft/4ft	80	0.27A	4000K	135
30W	4050lm	3ft/4ft	80	0.31A	4000K	135
45W	6080lm	4ft	80	0.39A	4000K	135
60W	7800lm	4ft	80	0.52A	4000K	130
90W	11700lm	4ft	80	0.75A	4000K	130
60W	8100lm	8ft	80	0.52A	4000K	135
80W	10800lm	8ft	80	0.67A	4000K	135

### Clear Lens

Wattage	Lumen Output	Size	CRI	AC Input 120V	CCT	LPW
20W	2840lm	2ft/4ft	80	0.27A	4000K	142
30W	4260lm	3ft/4ft	80	0.31A	4000K	142
45W	6390lm	4ft	80	0.39A	4000K	142
60W	8200lm	4ft	80	0.52A	4000K	137
90W	12300lm	4ft	80	0.75A	4000K	137
60W	8520lm	8ft	80	0.52A	4000K	142
80W	11360lm	8ft	80	0.67A	4000K	142

### NOTE:

1. Multiplier for 3500K is 0.97 .

## Projected LED Lumen Maintenance

Data references the extrapolated performance projections for the LED strip in a 77°F ambient, (tested per IESNA LM-80-08 and projected per IESNA TM-21-11).

Operating Hours	10,000	19,000	38,000	156,000
Lumen Maintenance Factor	0.98(L98)	0.96(L96)	0.92(L92)	0.70(L70)

## Lumen Ambient Temperature (LAT) Multipliers

Use these factors to determine relative lumen output for average ambient temperature from -4°F to 104°F (-20°C to 40°C).

Ambient		
Celsius	Fahrenheit	Multiplier
0	32	1.06
10	50	1.03
20	68	1.01
25	77	1.00
30	86	0.99
40	104	0.97

## MICROWAVE DIMMING SENSOR

The sensor is an innovative motion sensor, switch on the light on detection of movement, and switch off after a hold time when there is no motion detected.

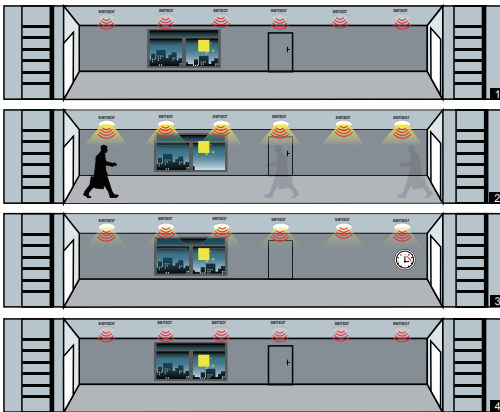

1. No motion detected, all lamps switch off.
2. Any movement is detected from any direction, all lamps synchronously switch on.
3. No motion is detected in detection area, all lamps synchronously dim to a low light level after hold time.
4. After stand-by period, the lamps switch off if no movement is detected in the detection zone.

## MICROWAVE DIMMING SENSOR SETTING (120-347V)

Sensor data can be precisely set for each specific application by a remote controller which need to be bought separately.

### Detection area

Detection area can be reduced by selecting the combination on the remote controller to fit precisely each application.  
Optional Setting: 100%/75%/50%/25%.

**Default Setting: 100%**

### Hold time

Refers to the time period the lamp remains at 100% illumination after no motion detected.  
Optional Setting: 5s/30s/1min/3min/5min/10min/20min/30min.

**Default Setting: 20mins**

### Stand-by period

Refers to the time period the lamp remains at a low light level before it completely switches off in the long absence of people. When set to “+∞” mode, the low light is maintained until motion is detected.

Optional Setting: 0s/10s/1min/3min/5min/10min/30min/+∞.

**Default Setting: +∞**

Notes: If just need ON/OFF function, please set the stand-by period in "OS" mode by the remote controller.

### Daylight sensor

The sensor can be set to only allow the lamp to illuminate below a defined ambient brightness threshold. When set to Disable mode, the daylight sensor will switch on the lamp when motion is detected regardless of ambient light level. 50lux, 30lux: twilight operation, 10lux, 5lux: darkness operation only. Note that daylight sensor is active only when lamp totally switches off.

Optional Setting: 5lux/15lux/30lux/50lux/100lux/150lux/Disable.

**Default Setting: Disable**

### Stand-by dimming level

The low light level you would like to have after the hold time in the long absence of people.

Optional Setting: 10%/20%/30%/50%.

**Default Setting: 50%**

## BLUETOOTH PIR MOTION SENSOR

Model No.	Description
BMS-L104-B1-PIR-1-BLE-KL-SMO	Passive Infrared (PIR) Bluetooth Sensor
LS03-HB1-2-WH	HB1 High Bay Lens
LS03-HB3-2-WH	HB3 High Bay Lens



## BLUETOOTH MESH CONTROL

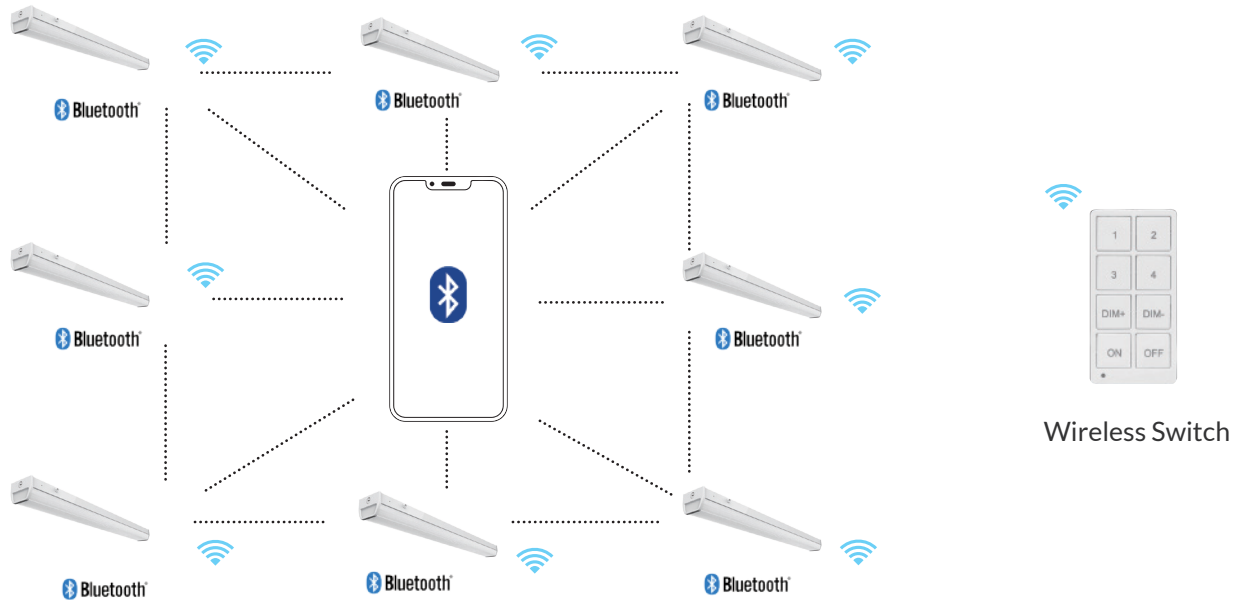

## WIRELESS SWITCH OPTIONS



BMWS-L-D-1-3BT-  
BLE-KL-WH



BMWS-L-D-5BT-  
BLE-KL-WH



BMWS-L-D-1-7  
BT-BLE-KL-WH



BMWS-L-D-8BT-  
BLE-KL-WH



## DETECTION AREA

### HB1 High Bay Lens

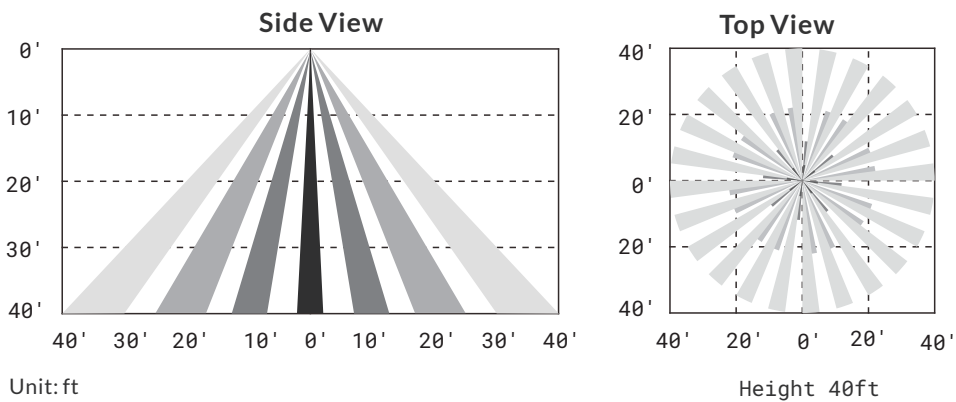

### HB3 High Bay Lens

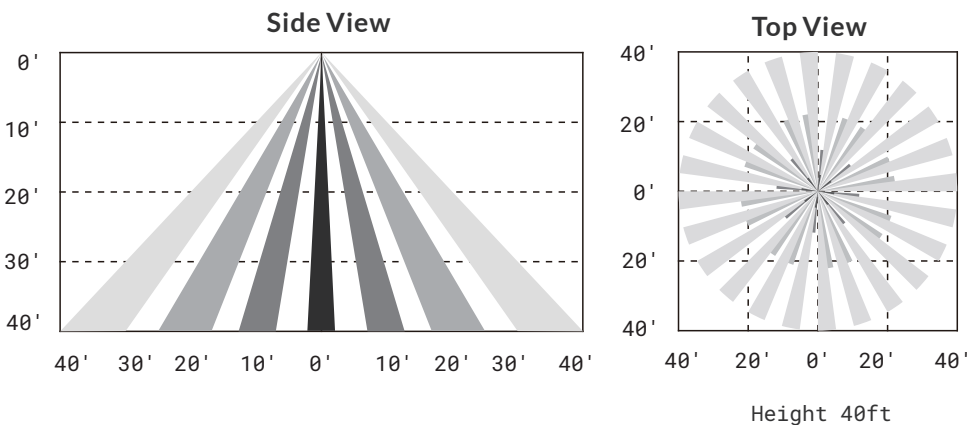

## DETECTING SPOTS FOR REF

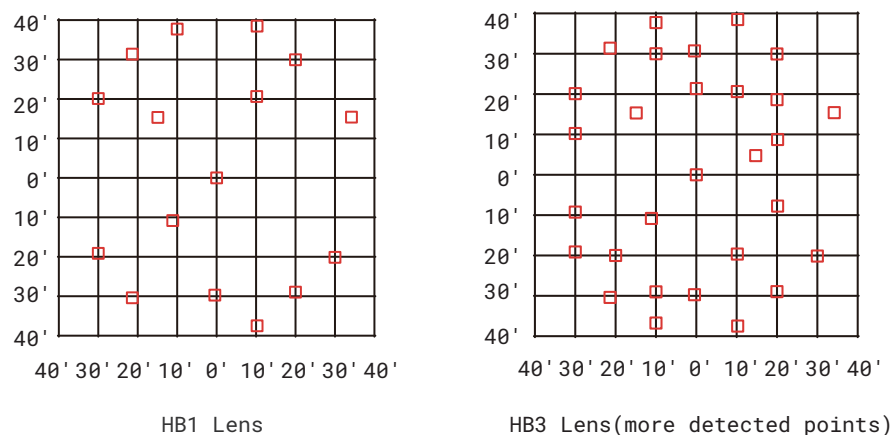

# ECO VISION LED STRIP

Wide Size Ideal To Replace The 2 Lamp Fluorescent Strip



**ABOVE ALL**

[www.AboveAllLighting.com](http://www.AboveAllLighting.com)

## WARRANTY

5 years limited warranty.

Specifications subject to change without notice

### **Note:**

Please refers to the instruction manual for motion sensor default setting.

Ref#: 20251209