



The Carlo LED Pole Light combines unmatched flexibility with resilient durability for dynamic outdoor lighting solutions. Its fully customizable pole height and finish color allow seamless integration into any setting, while the luminaire's selection of beam angles and versatile mounting methods enable tailored illumination for diverse applications—from pathways and parking lots to architectural landscapes.

## TECHNICAL DATA

<b>Wattage</b>	Single luminaire
	20W, 30W, 40W
<b>CCT</b>	2700K, 3000K, 4000K, 5000K
<b>Beam Angle</b>	15°, 24°, 36°, 50°, H50°*V20°
<b>CRI</b>	80
<b>Driver</b>	0-10V Dimming
<b>Input Voltage</b>	120-277V, 50/60Hz
<b>Projected Lifetime</b>	L70-100,000 hours
<b>Operating Temp.</b>	-4°F to 113°F (-20°C to 45°C)
<b>Certifications</b>	cETLus listed
	RoHS compliant
<b>Power Factor</b>	>0.9 at full load
<b>Harmonic Distortion</b>	<20% at full load
<b>IP Rating</b>	IP65

## FEATURES

- **Adjustability & Adaptability:** Customizable pole height and finish color. Selection of beam angles and mountings. 180° tiltable luminaire.
- **Durable Construction:** Die-cast aluminum housing. Polycarbonate Lens. Marine grade treatment available.
- **Smart Compatibility:** 0-10V dimming for enhanced control.
- **Visual Comfort Optimization:** Optional shrouds and honeycomb louvre for visual comfort.

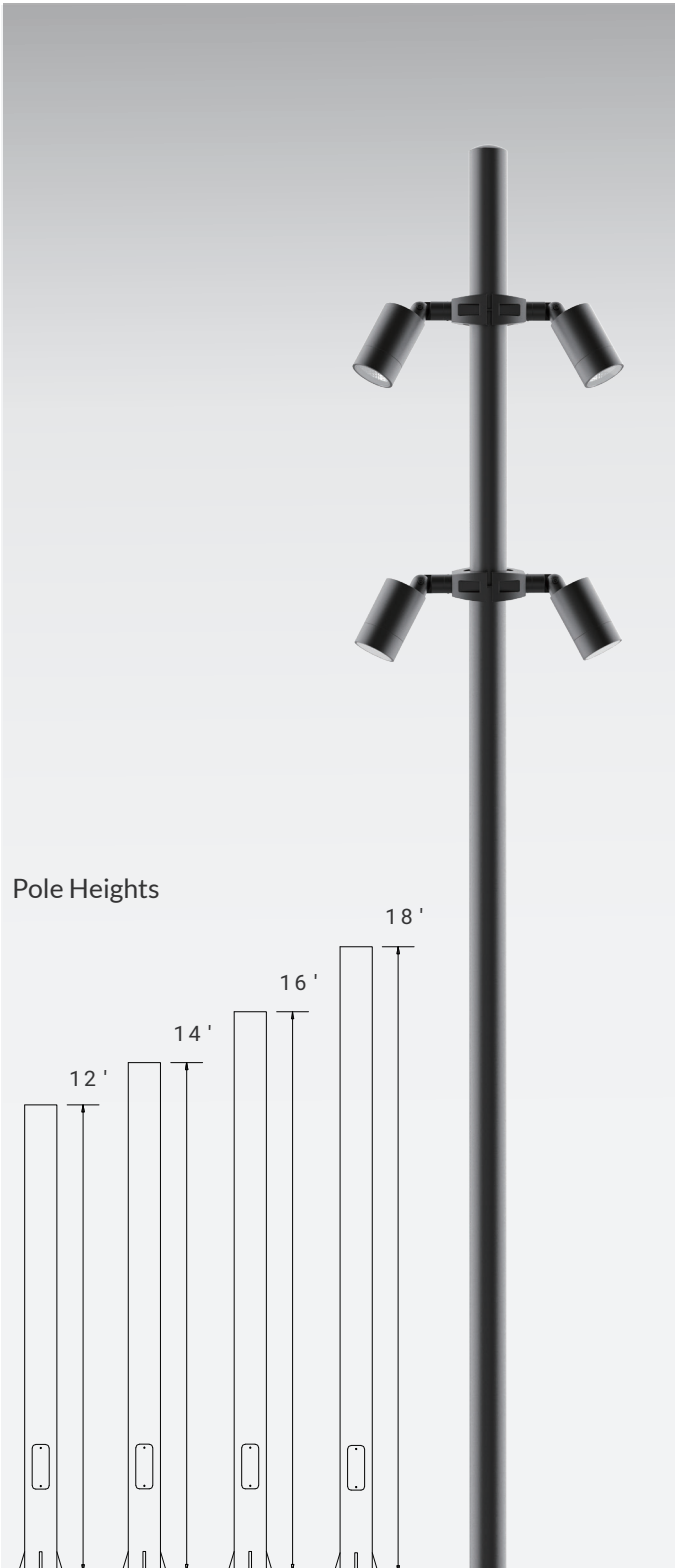

Pole Heights

## SPECIFICATION

### Pole Side View

Pole Wall Thickness: 0.125"

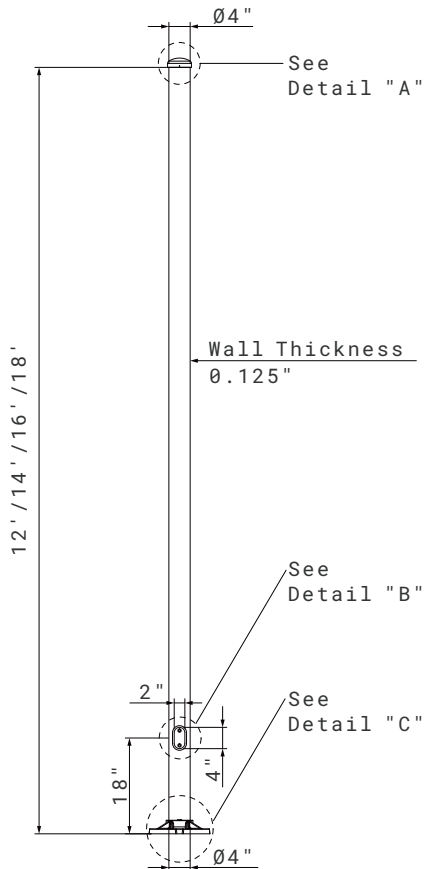

### Detail "A" - Pole Cap Detail

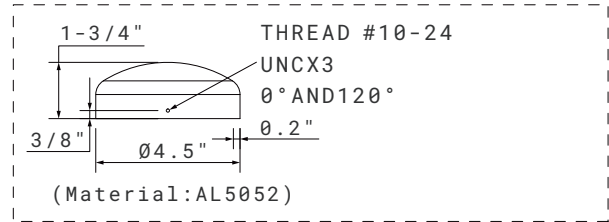

### Detail "B" - Door Detail

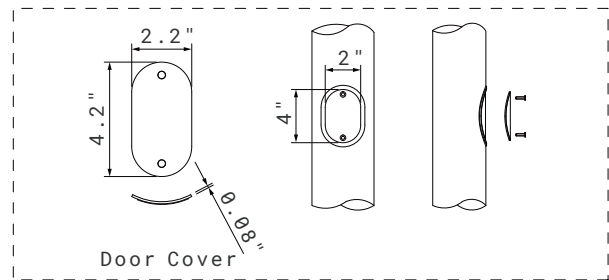

### Detail "C" - Pole Base Detail

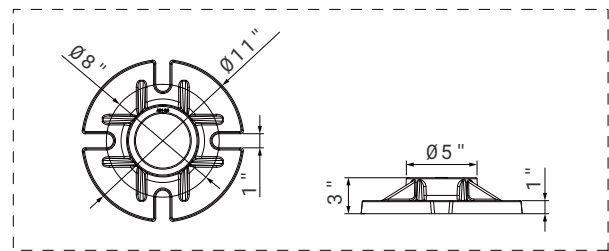

### Anchor Bolt Plate (2 pcs)

Use caution when setting anchor bolts. Bolts must be vertically straight and centered on dimensions shown.

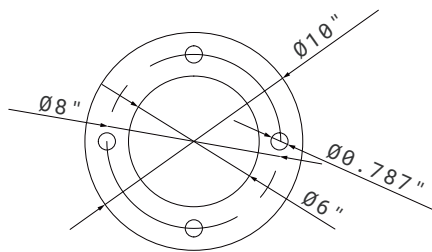

Thickness: 0.118" (3mm)

Note: Adequate drainage must be provided in concrete foundation.

### Anchor Bolt Detail

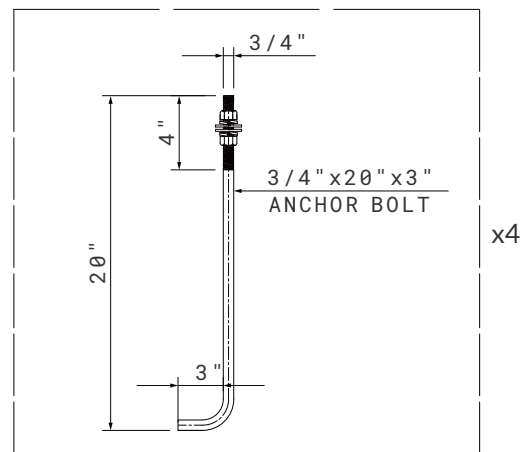

Anchor Bolt (for option)

## SPECIFICATION

Single Module 20W, 30W, 40W

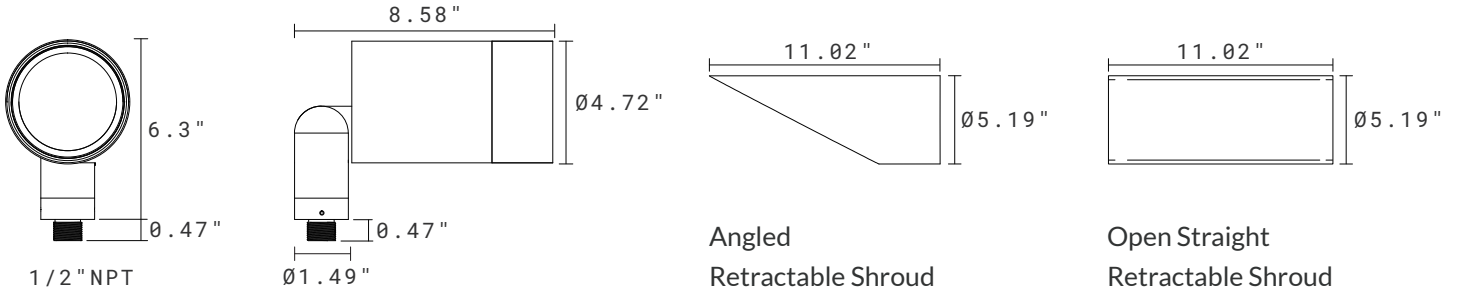

### Shrouds



No Shroud



Angled Retractable Shroud

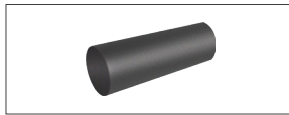

Open Straight Retractable Shroud

### Housing Color



Black  
RAL9011

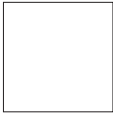

White  
RAL9016



Gray  
RAL7012



Mineral  
Bronze



Silver  
RAL9006

## ORDERING INFORMATION

EXAMPLE: CARLO-C20301-50-KNS-AS-BK-1.8FT

CARLO									
Series	Wattage	CCT	Voltage	Beam Angle	Mounting	Shroud	Housing Color	Cable Length	Option
CARLO	<b>C20</b> COB 20W	<b>27</b> 2700K	<b>1</b> 120-277V	<b>15</b> 15°	KNS Knuckle with 1/2 threaded Stem	<b>NS</b> No shroud	<b>BK<sup>1</sup></b> Black RAL9011	<b>1.8FT<sup>2</sup></b> <i>1.8ft cable is the standard cable length. Custom lengths are available at an additioal charge.</i>	<b>BLANK</b> None <b>M</b> Marine ambient corrosion resistance
	<b>C30</b> COB 30W	<b>30</b> 3000K		<b>24</b> 24°		<b>AS</b> Angled Retractable Shroud			
	<b>C40</b> COB 40W	<b>40</b> 4000K		<b>36</b> 36°		<b>OS</b> Open Straight Retractable Shroud	<i>Black &amp; Gray are standard finish colors. Custom colors are available at an additioal charge.</i>		
		<b>50</b> 5000K		<b>50</b> 50°			<b>WH</b> White RAL9016		
				<b>5020</b> H50° *V20°			<b>BZ</b> Mineral Bronze		
							<b>SL</b> Silver RAL9006		

**NOTE:**

1. Black and Gray are standard finish colors. Custom colors are available at an additional charge.
2. The standard cable length is 1.8ft. Custom cable lengths are available at an additional charge.

## ACCESSORIES (ORDERED SEPARATELY)

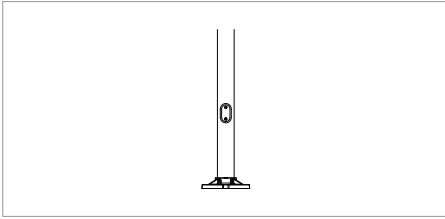

**ALRP4-12FT-0.125-BK**  
 Aluminum Round Pole Ø4", 12ft  
 Wall thickness: 0.125"  
 With pole cap, black.

**ALRP4-14FT-0.125-BK**  
 Aluminum Round Pole Ø4", 14ft  
 Wall thickness: 0.125"  
 With pole cap, black.

**ALRP4-16FT-0.125-BK**  
 Aluminum Round Pole Ø4", 16ft  
 Wall thickness: 0.125"  
 With pole cap, black.

**ALRP4-18FT-0.125-BK**  
 Aluminum Round Pole Ø4", 18ft  
 Wall thickness: 0.125"  
 With pole cap, black.

*Custom pole heights and finish colors available.*

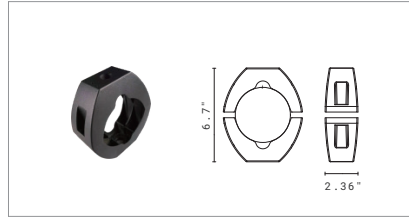

**HOFL-PCP-4-BK**  
 Pole Clamp for 1 or 2 fixtures, Pole  
 Dia. 4".

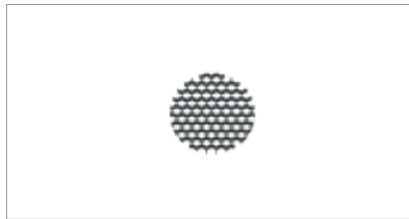

**CARLO-HCL-04**  
 Aluminum Honeycomb Louver.

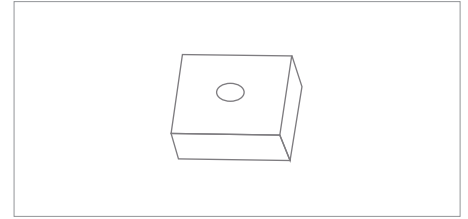

**PBC4-BK**  
 Pole Base Cover for Dia. 4" (O.D.) pole,  
 Black.

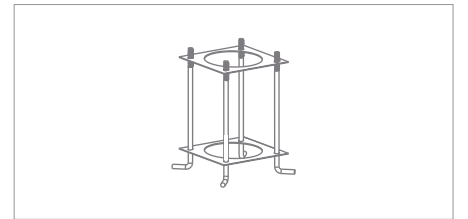

**ABMK-3/4"-8**  
 Galvanized Anchor Bolts Mounting  
 Kits for round pole.  
 Mounting hole: 8"x8"  
 Anchor bolts size: 3/4"x20"x3"

## PHOTOMETRY

All published luminaire photometric testing performed to IESNA LM-79-08 standards by a NVLAP certified laboratory. IESNA LM-79-08 specifies the entire luminaire as the source resulting in a fixture efficiency of 100%. Results may vary per actual order.

### 40W- 15°

LUMINOUS INTENSITY DISTRIBUTION DIAGRAM

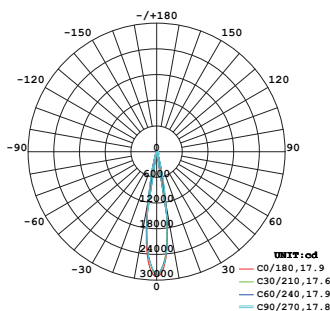

C0 PLANE ISOLUX DIAGRAM (UNIT:lx)

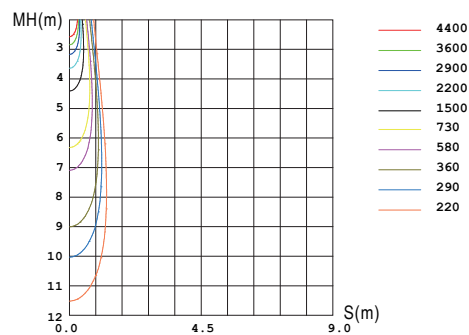

## PHOTOMETRY

All published luminaire photometric testing performed to IESNA LM-79-08 standards by a NVLAP certified laboratory. IESNA LM-79-08 specifies the entire luminaire as the source resulting in a fixture efficiency of 100%. Results may vary per actual order.

### 40W- 24°

LUMINOUS INTENSITY DISTRIBUTION DIAGRAM

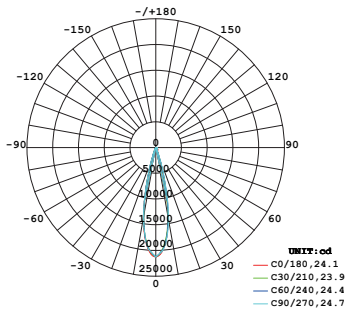

AVERAGE BEAM ANGLE(50%):24.3 DEG

C0 PLANE ISOLUX DIAGRAM (UNIT:lx)

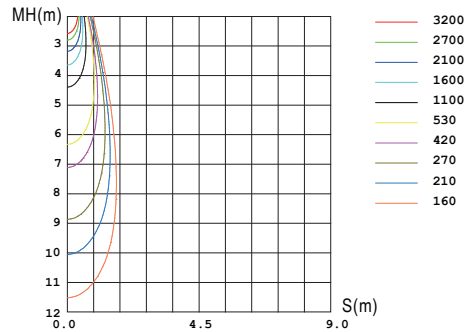

### 40W- 36°

LUMINOUS INTENSITY DISTRIBUTION DIAGRAM

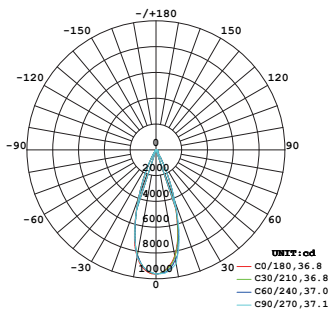

AVERAGE BEAM ANGLE(50%):36.9 DEG

C0 PLANE ISOLUX DIAGRAM (UNIT:lx)

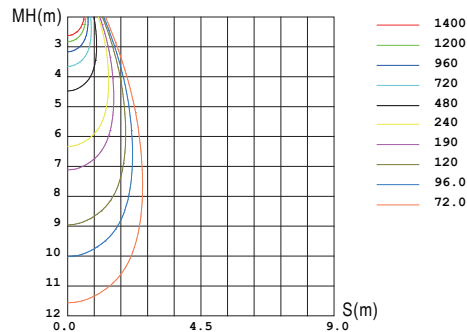

### 40W- 50°

LUMINOUS INTENSITY DISTRIBUTION DIAGRAM

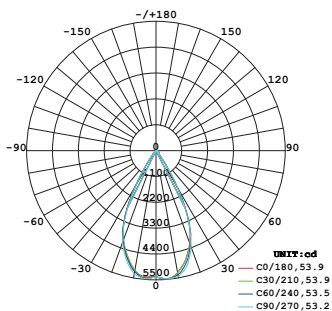

AVERAGE BEAM ANGLE(50%):53.6 DEG

C0 PLANE ISOLUX DIAGRAM (UNIT:lx)

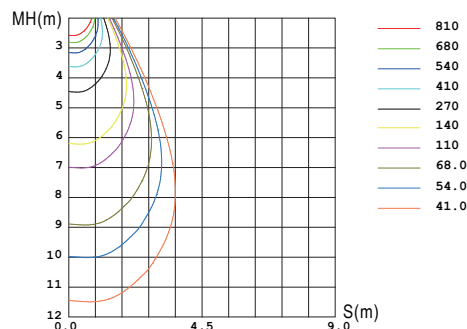

## PHOTOMETRY

All published luminaire photometric testing performed to IESNA LM-79-08 standards by a NVLAP certified laboratory. IESNA LM-79-08 specifies the entire luminaire as the source resulting in a fixture efficiency of 100%. Results may vary per actual order.

### 40W- H50°xV20°

LUMINOUS INTENSITY DISTRIBUTION DIAGRAM

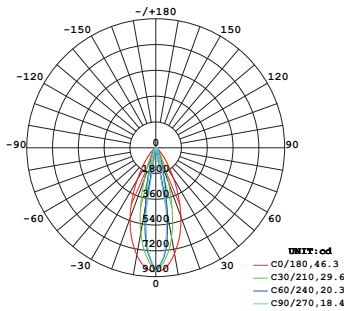

AVERAGE BEAM ANGLE(50%):28.7 DEG

C0 PLANE ISOLUX DIAGRAM (UNIT:lx)

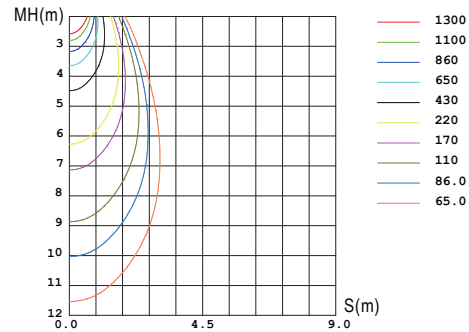

## PERFORMANCE DATA

Lumen values are measured by third party certified laboratories performed in accordance with IESNA LM-79-08 as well as Lighting Facts listed.

WATTAGE	BEAM ANGLE	LUMENS (lm)	CCT	CRI
20W	15°	2520lm	3000K	80
20W	24°	2161lm	3000K	80
20W	36°	2114lm	3000K	80
20W	50°	2131lm	3000K	80
20W	H50° x V20°	1608lm	3000K	80
30W	15°	2785lm	3000K	80
30W	24°	2936lm	3000K	80
30W	36°	2863lm	3000K	80
30W	50°	2936lm	3000K	80
30W	H50° x V20°	2159lm	3000K	80
40W	15°	3671lm	3000K	80
40W	24°	3958lm	3000K	80
40W	36°	3878lm	3000K	80
40W	50°	3924lm	3000K	80
40W	H50° x V20°	2878lm	3000K	80

## POLE DATA CHART

Pole Height	Wall Thickness	Pole Dimension(Ø)	Pole Material	Pole EPA	Max Basic Wind Speed
12ft	0.125"	Ø4"	Aluminum	5.928ft <sup>2</sup>	180 mph
14ft	0.125"	Ø4"	Aluminum	6.916ft <sup>2</sup>	160 mph
16ft	0.125"	Ø4"	Aluminum	7.904ft <sup>2</sup>	140 mph
18ft	0.125"	Ø4"	Aluminum	8.892ft <sup>2</sup>	130 mph

### NOTE:

1. The wind speed datas are based on allowable design wind speed (VASD).
2. Rated performance is dependant upon the pole being properly attached to a supporting foundation of adequate design.

## WARRANTY

Five year limited warranty.

Specifications subject to change without notice.