



The Holly LED Pole Light combines unmatched flexibility with resilient durability for dynamic outdoor lighting solutions. Its fully customizable pole height and finish color allow seamless integration into any setting, while the luminaire’s selection of beam angles and versatile mounting methods enable tailored illumination for diverse applications—from pathways and parking lots to architectural landscapes.

TECHNICAL DATA

Wattage

Single luminaire	26W, 42W, 86W, 120W
------------------	---------------------

CCT	2700K, 3000K, 3500K, 4000K, 5000K
-----	-----------------------------------

Beam Angle	5°, 15°, 24°, 36°, 50°
------------	------------------------

CRI	80
-----	----

Driver	0-10V Dimming
--------	---------------

Input Voltage	120-277V
---------------	----------

Projected Lifetime	L70-100,000 hours
--------------------	-------------------

Operating Temperature

C26	-4°F to 104°F (-20°C to 40°C)
-----	-------------------------------

C42/C86/C120	-40°F to 104°F (-40°C to 40°C)
--------------	--------------------------------

Certifications	cETLus listed
----------------	---------------

Power Factor	>0.9 at full load
--------------	-------------------

Harmonic Distortion	<20% at full load
---------------------	-------------------

IP Rating	65
-----------	----

FEATURES

- **Adjustability & Adaptability:** Customizable pole height and finish color. Selection of beam angles and mountings. 90° tiltable luminaire.
- **Durable Construction:** Die-cast aluminum housing. Akzo-Nobel powder coating. Marine grade treatment available.
- **Smart Compatibility:** 0-10V dimming for enhanced control.
- **Visual Comfort Optimization:** Optional full visor and honeycomb louvre for visual comfort.

Pole Clamp Mount



Pole Coupler Mount



SPECIFICATION

Pole Side View

Pole Wall Thickness: 0.125"

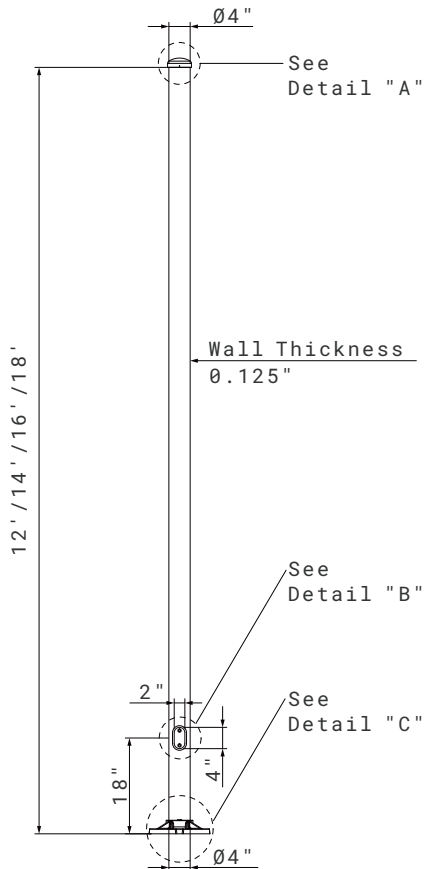

Detail "A" - Pole Cap Detail

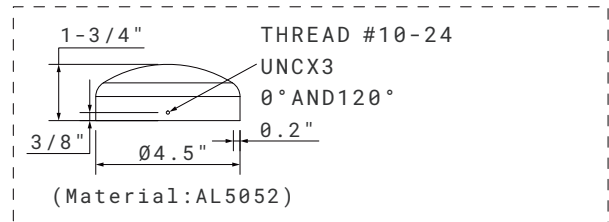

Detail "B" - Door Detail

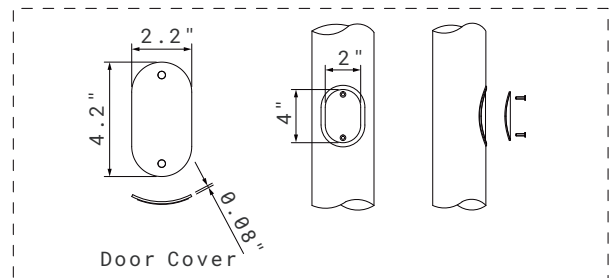

Detail "C" - Pole Base Detail

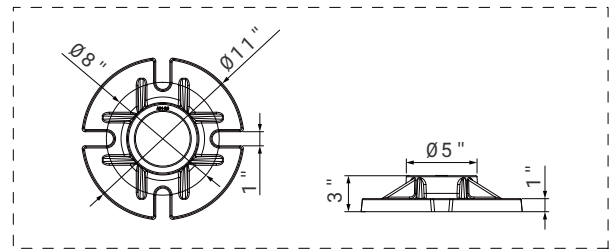

Anchor Bolt Plate (2 pcs)

Use caution when setting anchor bolts. Bolts must be vertically straight and centered on dimensions shown.

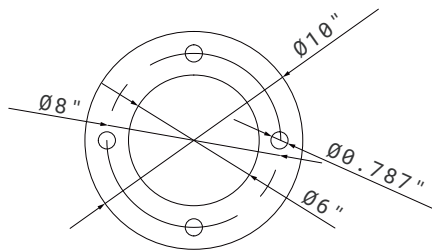

Thickness: 0.118" (3mm)

Note: Adequate drainage must be provided in concrete foundation.

Anchor Bolt Detail

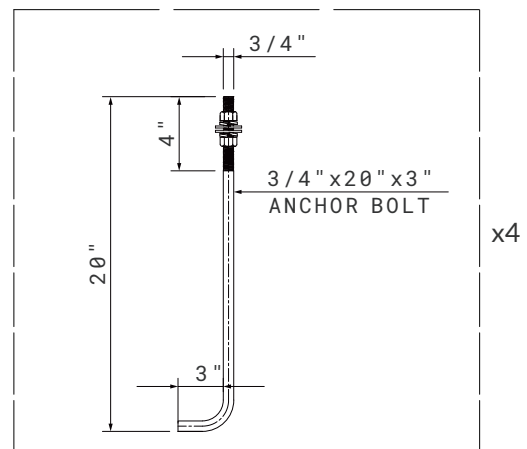

Anchor Bolt (for option)

*Please contact Customer Service for customized poles.

SPECIFICATION

Knuckle with 1/2" Threaded Stem

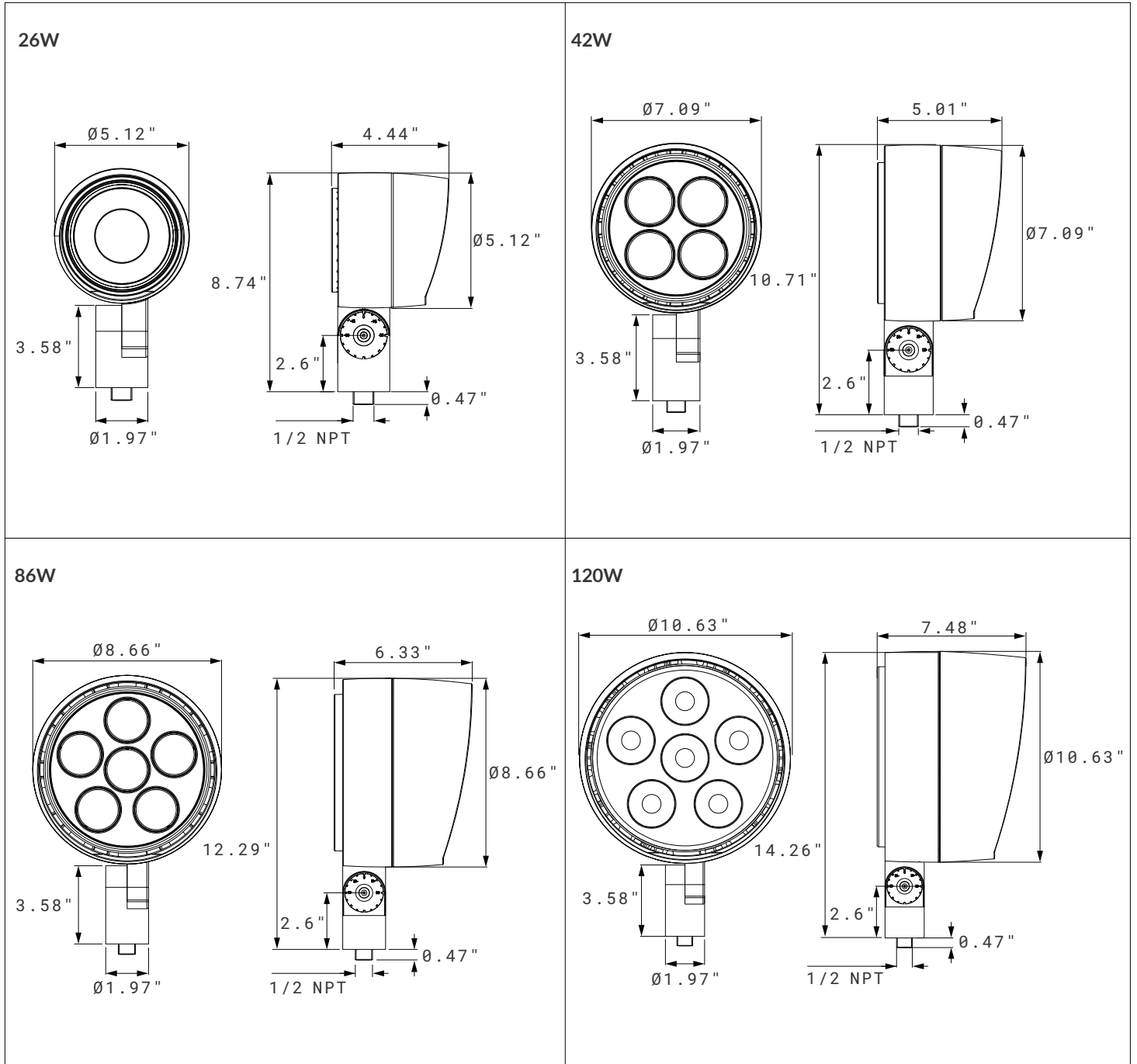

ORDERING INFORMATION

EXAMPLE: HOFL-C26301-24-KNS-BK-1.8FT

HOFL								
Series	Wattage	CCT	Voltage	Beam Angle	Mounting	Faceplate Finish	Cable Length	Option
HOFL	C26 26W	27 2700K	1 120-277V	5 5°	KNS Knuckle with 1/2 Threaded Stem	BK¹ Black RAL9011	1.8FT² <i>*1.8 FT cable is standard. Other cable lengths are available at an additional charge.</i>	BLANK None M Marine ambient corrosion resistance
	C42 42W	30 3000K		15 15°		GY¹ Gray RAL7012		
	C86 86W	35 3500K		24 24°		<i>Black & Gray are standard finish colors. Custom colors are available at an additional charge.</i>		
	C120 120W	40 4000K		36 36°		WH White RAL9016		
		50 5000K		50 50°		BZ Mineral bronze SL Silver RAL9006		

NOTE:

1. Black and Gray are standard finish colors. Custom colors are available at an additional charge.
2. Standard cable length is 1.8ft. Other cable lengths are available at an additional charge.

Housing Color



Black RAL9011



White RAL9016



Gray RAL7012



Mineral bronze



Silver RAL9006

ACCESSORIES (ORDERED SEPARATELY)

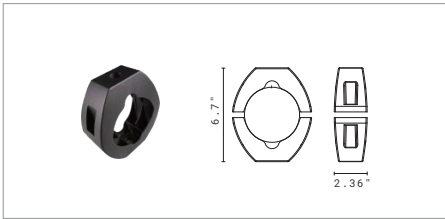

HOFL-PCP-4-BK

Pole Clamp for one or two fixtures,
Pole Dia. 4".

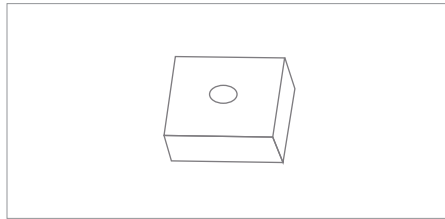

PBC4-BK

Pole Base Cover for Dia. 4" (O.D.) pole,
Black.

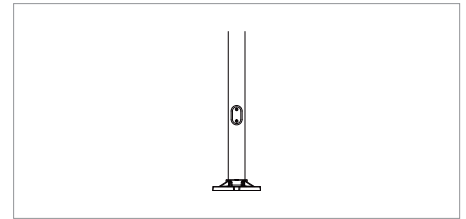

ALRP4-12FT-0.125-BK

Aluminum Round Pole Ø4", 12ft
Wall thickness: 0.125"
With pole cap, black.

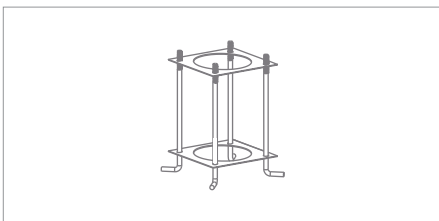

ABMK-3/4"-8

Galvanized Anchor Bolts Mounting
Kits for round pole.
Mounting hole: 8"x8"
Anchor bolts size: 3/4"x20"x3"

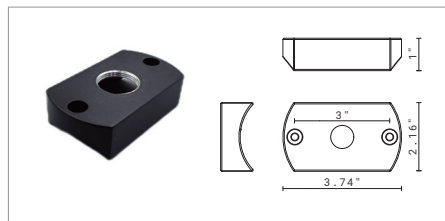

HOFL-PCR-BK

Pole coupler suitable for Dia.5" round
pole, Black.

ALRP4-14FT-0.125-BK

Aluminum Round Pole Ø4", 14ft
Wall thickness: 0.125"
With pole cap, black.

ALRP4-16FT-0.125-BK

Aluminum Round Pole Ø4", 16ft
Wall thickness: 0.125"
With pole cap, black.

ALRP4-18FT-0.125-BK

Aluminum Round Pole Ø4", 18ft
Wall thickness: 0.125"
With pole cap, black.

**Custom pole heights and finish colors
available.*

**Please contact Customer Service for
customized poles.*

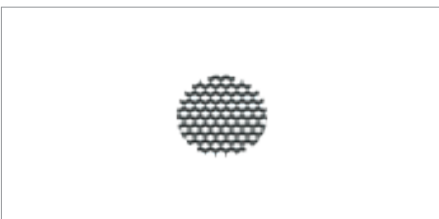

HOFL-HCL-50

Aluminum Honeycomb Louver,
Dia 1.97" for C26/C42/C86.

HOFL-HCL-62

Aluminum Honeycomb Louver,
Dia 2.44" for C120.



HOFL-FV-26

Full Visor for C26, Dia 5.31" x 3.94".

HOFL-FV-42

Full Visor for C42, Dia 7.28" x 5.12".

HOFL-FV-86

Full Visor for C86, Dia 8.86" x 6.3".

HOFL-FV-120

Full Visor for C120, Dia 10.83" x 7.48".

PERFORMANCE DATA

Lumen values are measured by third party certified laboratories performed in accordance with IESNALM-79-08 as well as Lighting Facts listed.

WATTAGE	LUMENS (lm)	BEAM ANGLE	CCT	CRI
26W	2200 lm	15° / 24° / 36° / 50°	3000K	80
42W	4000 lm	15° / 24° / 36° / 50°	3000K	80
86W	7300 lm	15° / 24° / 36° / 50°	3000K	80
120W	10000 lm	15° / 24° / 36° / 50°	3000K	80

**Apply lumen multiplier 0.6 for beam angle of 5°.*

PHOTOMETRY

All published luminaire photometric testing performed to IESNA LM-79-08 standards by a NVLAP certified laboratory. IESNA LM-79-08 specifies the entire luminaire as the source resulting in a fixture efficiency of 100%. Results may vary per actual order.

5°-3000K

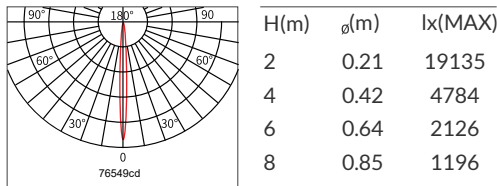

36°-3000K

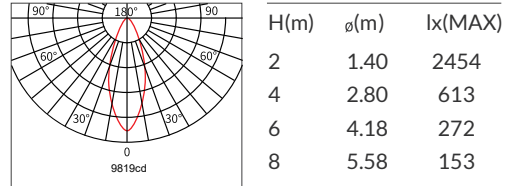

15°-3000K

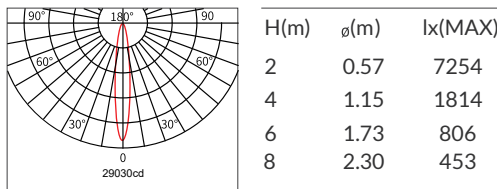

50°-3000K

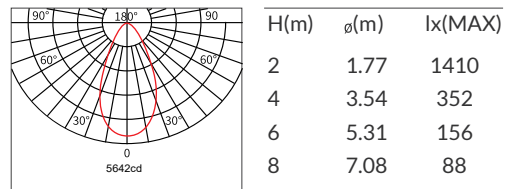

24°-3000K

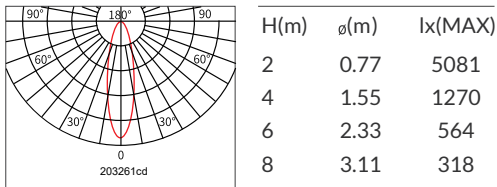

POLE DATA CHART

Pole Height	Wall Thickness	Pole Dimension(Ø)	Pole Material	Pole EPA	Max Basic Wind Speed
12ft	0.125"	Ø4"	Aluminum	5.928ft ²	180 mph
14ft	0.125"	Ø4"	Aluminum	6.916ft ²	160 mph
16ft	0.125"	Ø4"	Aluminum	7.904ft ²	140 mph
18ft	0.125"	Ø4"	Aluminum	8.892ft ²	130 mph

NOTE:

1. The wind speed datas are based on allowable design wind speed (VASD).
2. Rated performance is dependant upon the pole being properly attached to a supporting foundation of adequate design.

WARRANTY

Five year limited warranty.

Specifications subject to change without notice.